

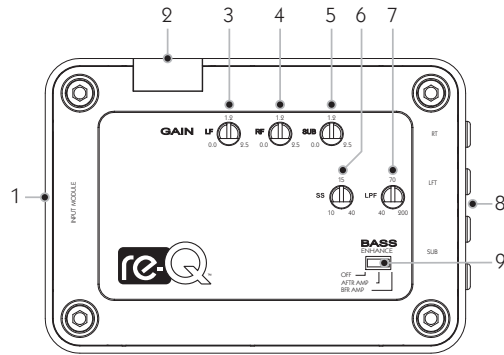

VOLUME SENSING BASS RESTORATION DEVICE™

re-Q is designed to restore bass when adding aftermarket amplifiers to a factory audio system. Most OEM systems “roll off” the bass to avoid damaging the speakers at higher volume levels. While this is acceptable when using stock speakers, it’s not desired when adding amplifiers as it limits the low frequency output of your system. Some try to fix this problem by maxing out the gains of an amplifier for added bass response at higher volumes, but when the volume is turned down, there is too much bass for the midrange and highs.

re-Q solves these problems by sensing the input from the head unit to add more bass at high volume levels, and balances the bass response at lower volume levels. You get the bass you want with added performance while keeping your factory radio and your steering wheel controls.



re-Q Features

- 1. Molex Connector Input
- 2. Power/Remote Output Indicator
- 3. Left Gain
- 4. Right Gain
- 5. Sub Gain
- 6. Subsonic Crossover
- 7. Low Pass Crossover
- 8. (2) Low Level RCA Outputs
- 9. Bass Enhancement Switch

Molex® Connector Wiring

- Blue - Remote Out
- White/Black - Left Front (-)
- White - Left Front (+)
- Brown/Black - Sub (-)
- Brown - Sub (+)
- Grey/Black - Right Front (-)
- Grey - Right Front (+)
- Red - Remote In
- Black - Chassis Ground
- Yellow - 12VDC (Constant)

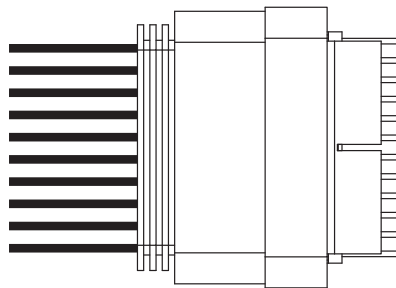

Installation

re-Q recommends that you have your device installed by an authorized re-Q dealer, preferably MECP certified.

- 1 - Disconnect the negative battery terminal from your battery.
- 2 - Disconnect factory speakers and subwoofer (if applicable). Connect to signal in of the re-Q.

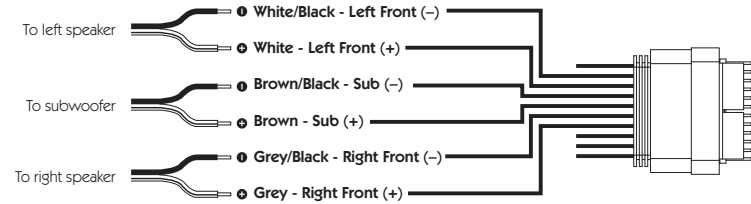

Tap into the factory speaker wires. Be sure to connect to the wiring at a point in the line that is receiving the signal AFTER amplification from an external amplifier or the amplifier built into the head unit. This is best achieved by connecting to the wires that are going directly to the speakers. Tap into the left channel using the White wires and the right channel using the Grey wires, making certain the ones with black stripes are tapped into the negative speaker wire.

For OEM systems without a factory subwoofer, do not connect the Sub input wire on re-Q. If the factory system is equipped with a subwoofer, connect the brown wires by tapping into the speaker wire going directly to the sub. NOTE: If adding an aftermarket subwoofer with your amplifier, it may be advisable to disconnect your factory subwoofer for the best sound.

- 3 - Connect 12V, Remote In (if not using smart engage), and ground.

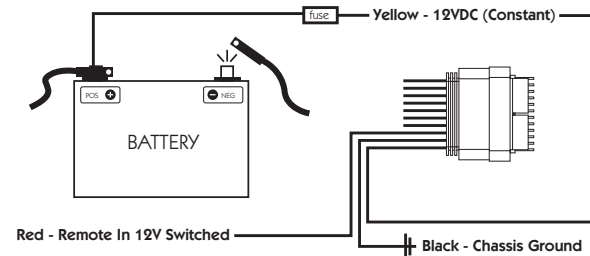

Using the provided fuse connect the Yellow (12VDC Constant) power wire from the Molex connector to the power source by tapping off your amplifier’s power wire or by running a separate wire directly to a fused constant 12V source.

Connect the Red (Remote In) wire from the Molex connector to a switched 12V supply. **NOTE:** If using Smart Engage™ or auto-sensing turn-on system, you do not need to connect the remote wire; simply cap the wire to prevent it from shorting the system.

Connect the black (Chassis Ground) wire to the chassis of the vehicle. Scrape off all the paint to connect directly to the bare metal of the chassis. When using re-Q as a ground loop isolator, be sure to ground this wire in the same location as the amplifier ground.

4 - Connect Remote Out and RCA cables to amplifier(s)

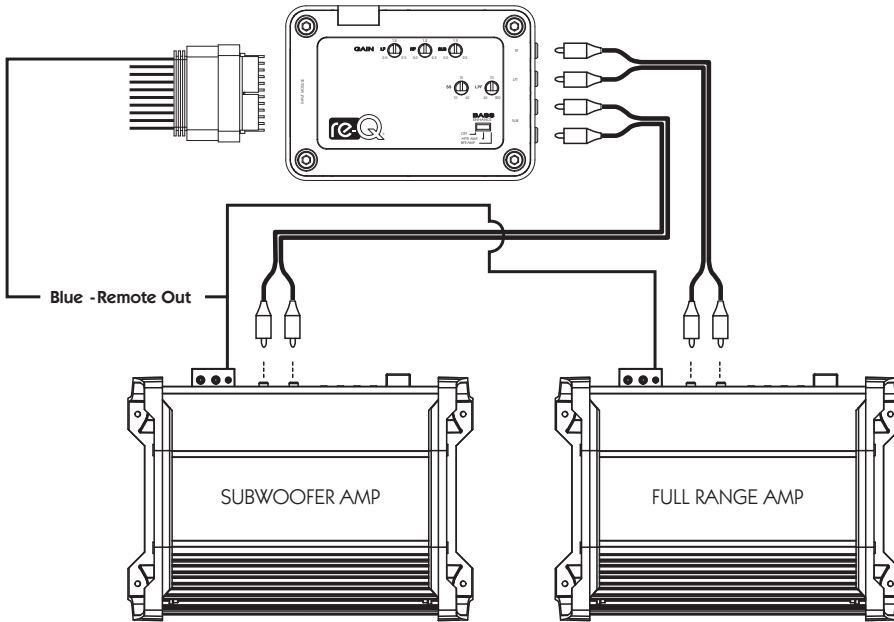

6 - Connect amplifier(s) to desired speakers and subwoofer(s)

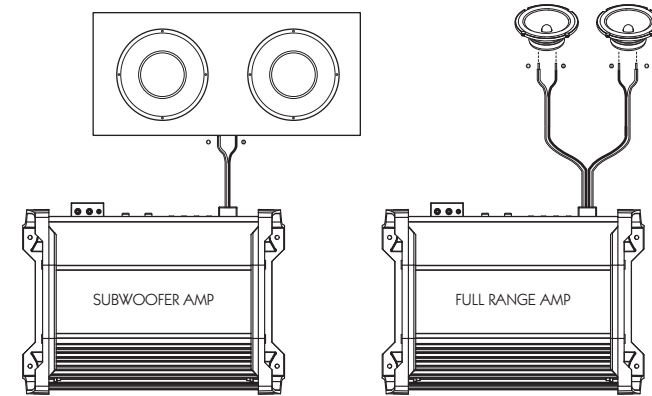

7 - Mount re-Q and reconnect the negative battery terminal to your battery

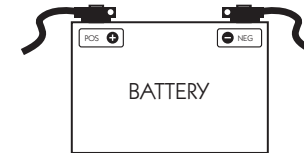

5 - Plug the Molex connector into the input slot on re-Q.

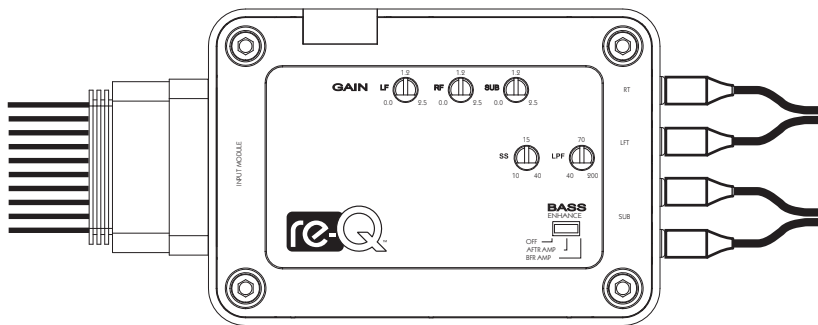

8 - Adjust the settings to maximize the performance of your system.

- 1) Set all amplifier gains and bass controls to a minimum.
- 2) Turn all settings on re-Q to their middle positions and the Bass Enhance switch to "AFTR AMP."
- 3) Set factory head unit to maximum desired listening level.
- 4) Adjust gain on full range amp to desired listening level.
- 5) Adjust gain on sub amp to desired listening level.
- 6) Adjust amplifier crossovers.
- 7) If applicable, adjust amplifier bass boost.
- 8) Fine tune system using re-Q gain and crossover controls
- 9) Listen to system at low and high volumes. If bass compensation is not enough, move Bass Enhance switch to "BFR AMP" setting and repeat adjustment steps 3 through 8.

